

## 60 SERİSİ PVC PROFİL SİSTEMİ

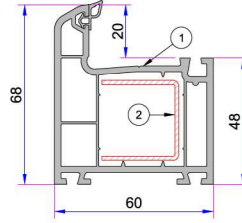

1. Süper Kasa Profili  
P.A.632.1001.600
2. Destek Sacı (29x30x29)  
1,2mm 34022-12002  
1,5mm 34022-15002  
2 mm 34022-20002

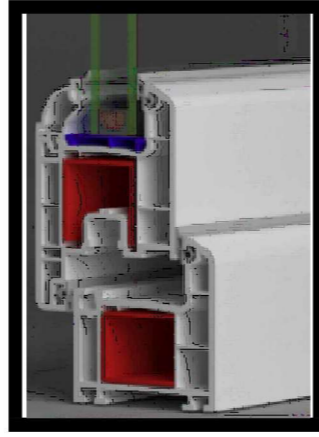
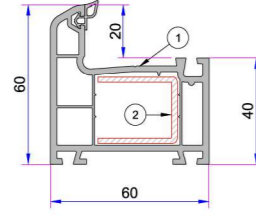

1. Kasa Profili  
P.A.632.1000.600
2. Destek Sacı (30x25x30)  
1,2mm 34022-12004  
1,5mm 34022-15004  
2 mm 34022-20004

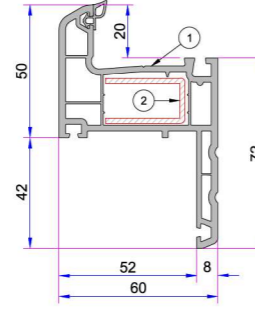

1. Pervazlı Kasa Profili  
P.A.632.1200.600
2. Destek Sacı (30x17x30)  
1,2mm 34022-12032  
1,5mm 34022-15032  
2 mm 34022-20032

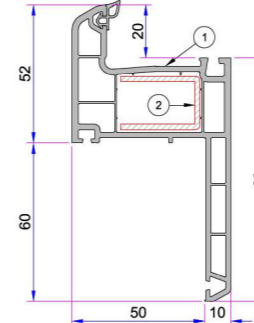

1. 60mm Pervazlı Kasa Profili  
P.A.632.1207.600
2. Destek Sacı (30x20x30)  
1,2mm 34022-12006  
1,5mm 34022-15006  
2 mm 34022-20006

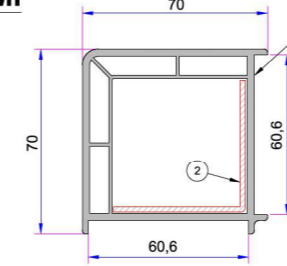

1. 90° Köşe Profili  
P.A.060.5100.600
2. Destek Sacı (50x50)  
1,2mm - 34022 - 12302  
1,5mm - 34022 - 15302  
2 mm - 34022 - 20302

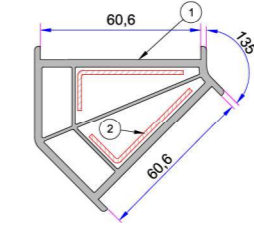

1. 135° Köşe Profili  
P.A.060.5102.600
2. Destek Sacı (15x40)  
1,2mm - 34022 - 12301  
1,5mm - 34022 - 15301  
2 mm - 34022 - 20301

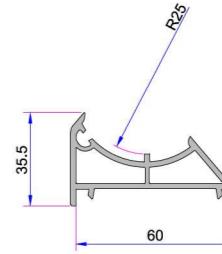

- Açılı Köşe Dönüş Aparatı  
P.A.060.5104.600

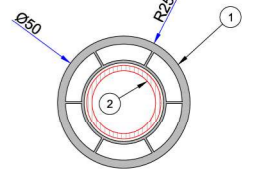

1. Açılı Köşe Dönüş Borusu Profili  
P.A.050.5106.600
2. Destek Sacı (Ø42)  
1,2mm - 34022 - 12503  
1,5mm - 34022 - 15503  
2 mm - 34022 - 20503

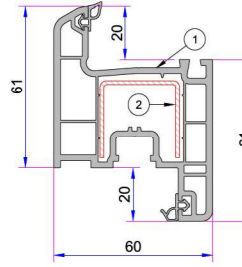

1. Kanat Profili  
P.A.632.2000.600
2. Destek Sacı (29x30x29)  
1,2mm 34022-12002  
1,5mm 34022-15002  
2 mm 34022-20002

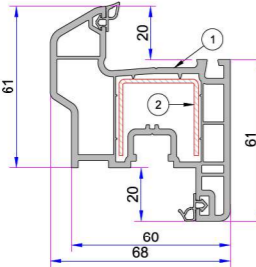

1. Damlalıklı Kanat Profili  
P.A.632.2200.600
2. Destek Sacı (29x30x29)  
1,2mm 34022-12002  
1,5mm 34022-15002  
2 mm 34022-20002

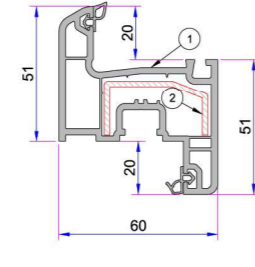

1. Dar Kanat Profili  
P.A.900.2005.600
2. Destek Sacı (29x30x15)  
1,2mm 34022-12031  
1,5mm 34022-15031  
2 mm 34022-20031

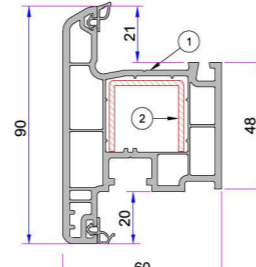

1. Dışa Açılım Kanat Profili (9aks)  
P.A.430.2001.600
2. Destek Sacı (27x28x27)  
1,2mm 34022-12020  
1,5mm 34022-15020  
2 mm 34022-20020

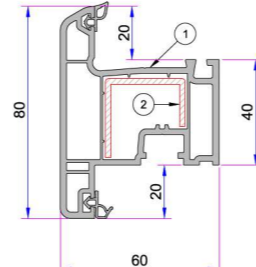

1. Dışa Açılım Kanat Profili (22aks)  
P.A.632.2014.600
2. Destek Sacı (30x30x18)  
1,2mm 34022-12022  
1,5mm 34022-15022  
2 mm 34022-20022

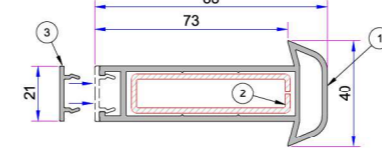

1. Ünlusal Kalın Bağ Profili  
P.A.058.5000.600
2. Destek Sacı (15x60)  
1,2mm - 34022 - 12123  
1,5mm - 34022 - 15123  
2 mm - 34022 - 20123
3. Ünlusal Kalın Bağ Kapak Profili  
P.A.058.5707.600

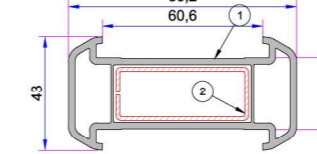

1. Kalın Bağ Profili  
P.A.060.5000.600
2. Destek Sacı (20x50)  
1,2mm - 34022 - 12105  
1,5mm - 34022 - 15105  
2 mm - 34022 - 20105

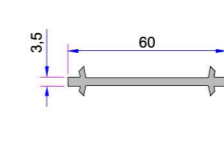

1. İnce Bağ Profili  
P.A.060.5101.600

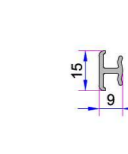

- Ortak Kısa Bağ Profili  
P.A.099.5004.600

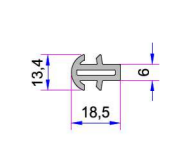

- Kısa Bağ Profili  
P.A.099.5003.600

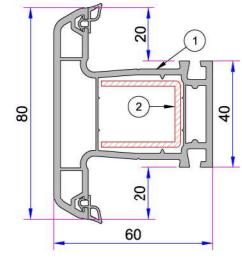

1. Orta Kayıt Profili  
P.A.632.3000.600
2. Destek Sacı (30x25x30)  
1,2mm 34022-12004  
1,5mm 34022-15004  
2 mm 34022-20004

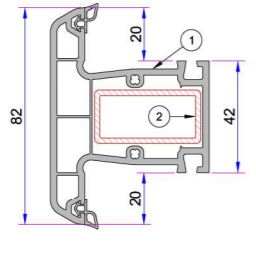

1. Statik Orta Kayıt Profili  
P.A.900.3003.600
2. Destek Sacı (20x40)  
1,2mm 34022-12114  
1,5mm 34022-15114  
2 mm 34022-20114

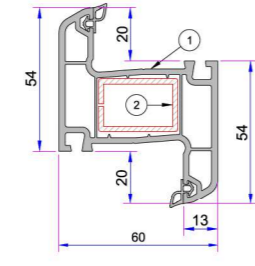

1. Dışa Açılım Orta Kayıt Profili  
P.A.632.3005.600
2. Destek Sacı (20x30)  
1,2mm 34022-12109  
1,5mm 34022-15109  
2 mm 34022-20109

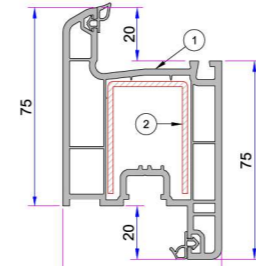

1. Dar Kapı Kanat Profili  
P.A.900.2107.600
2. Destek Sacı (42x30x42)  
1,2mm 34022-12023  
1,5mm 34022-15023  
2 mm 34022-20023

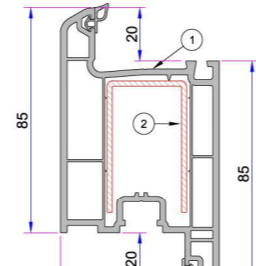

1. Kapı Kanat Profili  
P.A.632.2100.600
2. Destek Sacı (50x30x50)  
1,2mm 34022-12013  
1,5mm 34022-15013  
2 mm 34022-20013

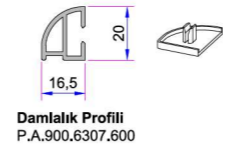

- Damlalık Profili  
P.A.900.6307.600

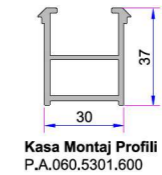

- Kasa Montaj Profili  
P.A.060.5301.600

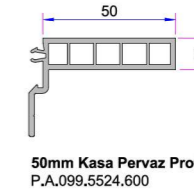

- 50mm Kasa Pervaz Profili  
P.A.099.5524.600

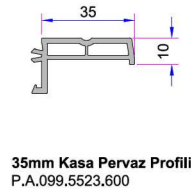

- 35mm Kasa Pervaz Profili  
P.A.099.5523.600

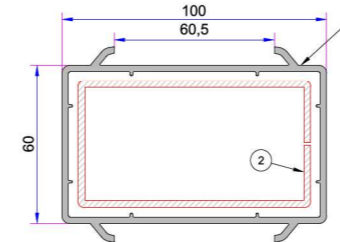

1. Tırnaklı Kutu Profili (70x100)  
P.A.060.5203.600
2. Destek Sacı (60x90)  
1,2mm - 34022 - 12102  
1,5mm - 34022 - 15102  
2 mm - 34022 - 20102

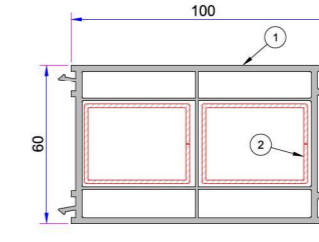

1. Kasa Yükseltme Profili (60x100)  
P.A.060.5300.600
2. Destek Sacı (30x40)  
1,2mm - 34022 - 12120  
1,5mm - 34022 - 15120  
2 mm - 34022 - 20120

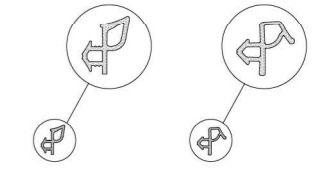

- Kasa Contası Kanat Contası

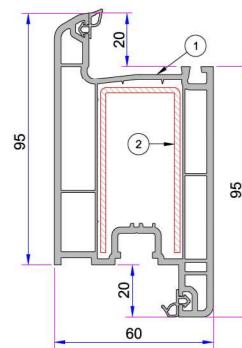

1. Süper Kapı Kanat Profili  
P.A.900.2103.600
2. Destek Sacı (62x30x62)  
1,2mm 34022-12029  
1,5mm 34022-15029  
2,0mm 34022-20029

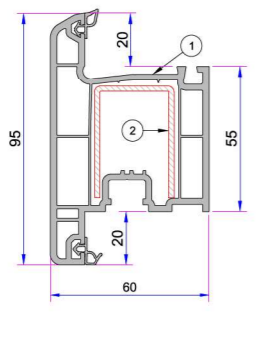

1. Eko Dışa Açılım Kapı Kanat Profili  
P.A.632.2108.600
2. Destek Sacı (42x30x42)  
1,2mm 34022-12023  
1,5mm 34022-15023  
2,0mm 34022-20023

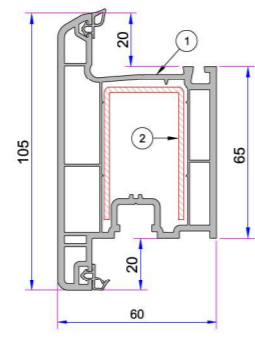

1. Dışa Açılım Kapı Kanat Profili  
P.A.632.2101.600
2. Destek Sacı (42x30x42)  
1,2mm 34022-12023  
1,5mm 34022-15023  
2,0mm 34022-20023

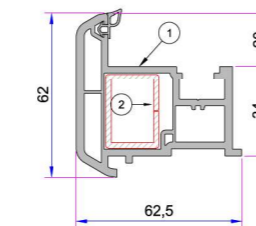

1. Hareketli Orta Kayıt Profili  
P.A.632.3100.600
2. Destek Sacı (20x28)  
1,2mm 34022-12118  
1,5mm 34022-15118  
2,0mm 34022-20118

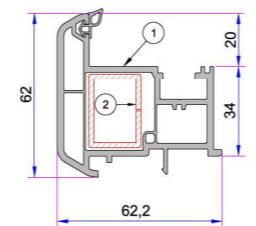

1. Tırnaklı Hareketli Orta Kayıt Profili  
P.A.632.3104.600
2. Destek Sacı (20x28)  
1,2mm 34022-12118  
1,5mm 34022-15118  
2,0mm 34022-20118

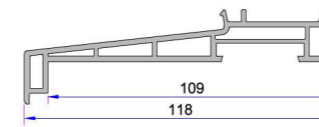

- Pervaz Profili  
P.A.058.5504.600

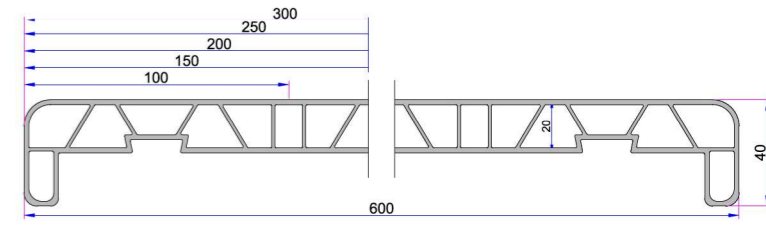

- PVC Denizlik Profili (600mm)  
P.DNZ.01.60.E.600

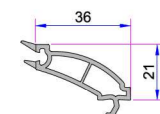

- 4-6mm Tek Cam Çıtası  
P.A.101.4002.600.0.HC

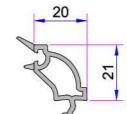

- 20mm Dekoratif Çift Cam Çıtası  
P.A.101.4102.600.0.HC

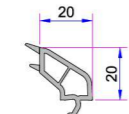

- 20mm Çift Cam Çıtası  
P.A.101.4100.600.0.HC

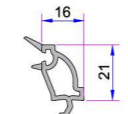

- 24mm Dekoratif Çift Cam Çıtası  
P.A.101.4202.600.0.HC

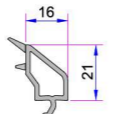

- 24mm Çift Cam Çıtası  
P.A.750.4500.600.0.HC

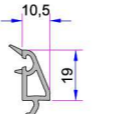

- 30mm Üçlü Cam Çıtası  
P.A.332.4100.600.0.HC

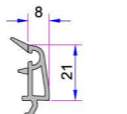

- 32mm Üçlü Cam Çıtası  
P.A.101.4500.600.0.HC

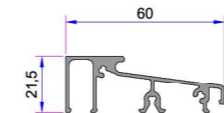

- Alüminyum Kapı Eşik Profili  
AD16-001

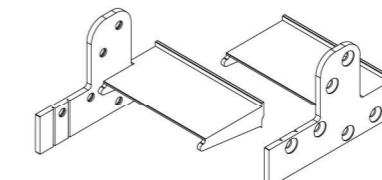

- Alüminyum Kasa Eşik Takozu  
221013.0000.L - 221013.0000.R

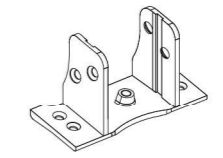

- Orta Kayıt Bağlantı Takozu  
34007-11040

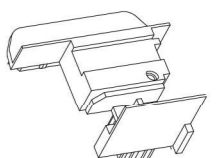

- Hareketli Orta Kayıt Kapağı  
34012-10090