

1. Sürme Kasa Profili (Çift Ray)
P.A.232.1106.600
2. Destek Sacı (30x20x30)
1,2mm - 34022 - 12006
1,5mm - 34022 - 15006
2 mm - 34022 - 20006

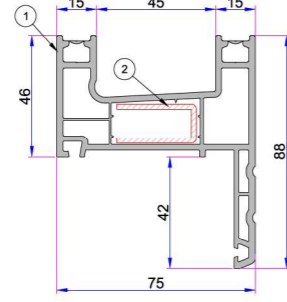

1. Sürme Kasa Profili (Dekoratif Pervazlı)
P.A.232.1107.600
2. Destek Sacı (30x15x30)
1,2mm - 34022 - 12034
1,5mm - 34022 - 15034
2 mm - 34022 - 20034

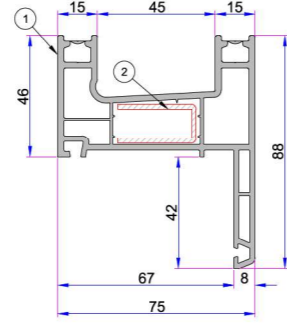

1. Sürme Kasa Profili (Düz Pervazlı)
P.A.232.1110.600
2. Destek Sacı (30x15x30)
1,2mm - 34022 - 12034
1,5mm - 34022 - 15034
2 mm - 34022 - 20034

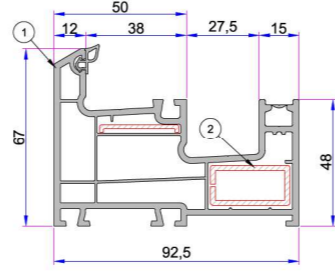

- Tek Ray Sürme Kasa Profili**
P.A.232.1105.600
1. Destek Sacı (30x15)
1,2mm - 34022 - 12135
1,5mm - 34022 - 15125
2 mm - 34022 - 20125

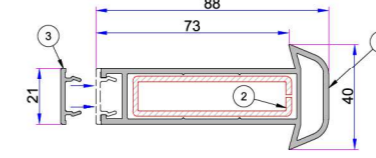

1. Ünsel Kalın Bağ Profili
P.A.058.5000.60
2. Destek Sacı (15x60)
1,2mm - 34022 - 12123
1,5mm - 34022 - 15123
2 mm - 34022 - 20123
3. Ünsel Kalın Bağ Kapak Profili
P.A.058.5707.600

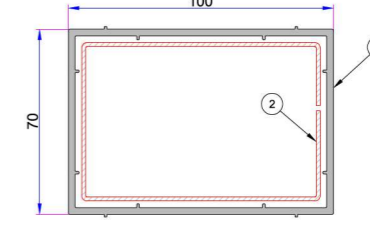

1. Kutu Profili (70x100)
P.A.070.5202.600
2. Destek Sacı (60x90)
1,2mm - 34022 - 12121
1,5mm - 34022 - 15121
2 mm - 34022 - 20121

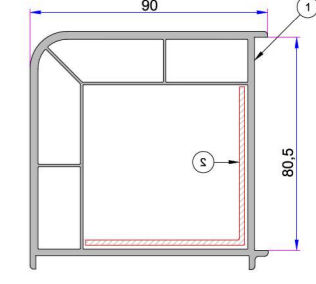

1. 90° Köşe Profili
P.A.080.5100.600
2. Destek Sacı (60x60)
1,2mm - 34022 - 12306
1,5mm - 34022 - 15306
2 mm - 34022 - 20306

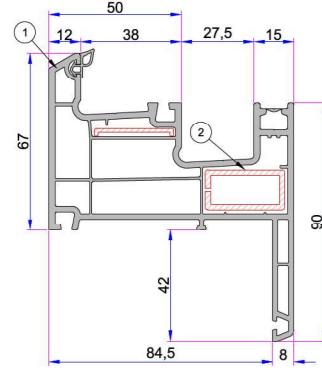

1. Tek Ray Sürme Kasa (Pervazlı)
P.A.232.1114.600
2. Destek Sacı (30x15)
1,2mm - 34022 - 12135
1,5mm - 34022 - 15135
2 mm - 34022 - 20135

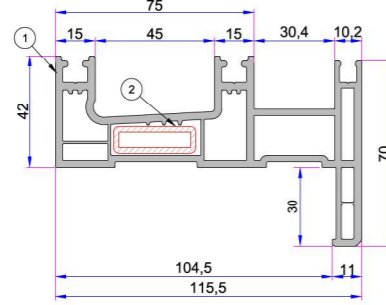

1. İç Sineklik Raylı Sürme Kasa Profili
P.A.242.1104.600
2. Destek Sacı (30x10)
1,2mm - 34022 - 12107
1,5mm - 34022 - 15107
2 mm - 34022 - 20107

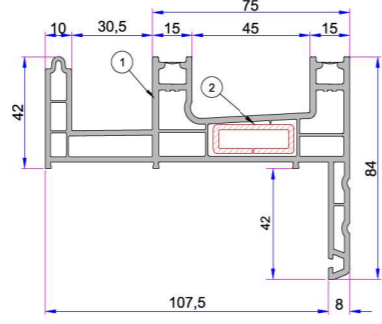

1. Dış Sineklik Raylı Sürme Kasa Profili
P.A.232.1109.600
2. Destek Sacı (30x11)
1,2mm - 34022 - 12107
1,5mm - 34022 - 15107
2 mm - 34022 - 20107

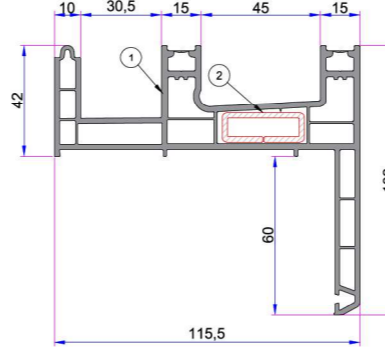

1. 60mm Pervazlı - Sineklikli Kasa Profili
P.A.232.1115.600
2. Destek Sacı (30x11)
1,2mm - 34022 - 12107
1,5mm - 34022 - 15107
2 mm - 34022 - 20107

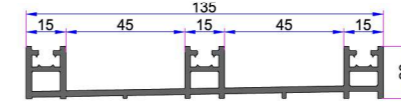

Alm. Sürme 3 Raylı Eşik Profili
AD16-035



Alüminyum Sürme Ray
AD16-014 PRES



Alüminyum Sürme Ray
AD-16-053

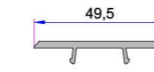

PVC Kanat Arka Kapama Profili
P.A.232.5704.650

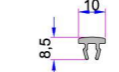

Kasa Kanal Kapama
P.A.232.5703.600

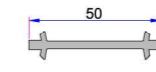

Bağ Profili
P.A.050.5001.600



PVC Kanat Ara Bindirme
P.A.232.5301.650



Ortak Kısa Bağ Profili
P.A.099.5004.600

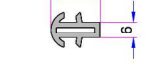

Kısa Bağ Profili
P.A.099.5003.600

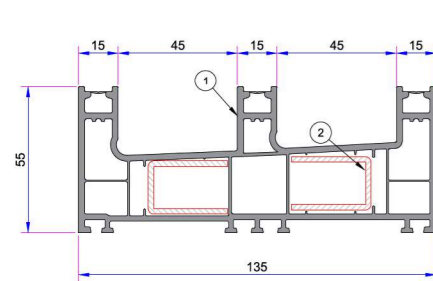

1. Üç Raylı Kasa Profili
Profil YENİ Yapılacak
2. Destek Sacı (30x20x30)
1,2mm - 34022 - 12006
1,5mm - 34022 - 15006
2 mm - 34022 - 20006

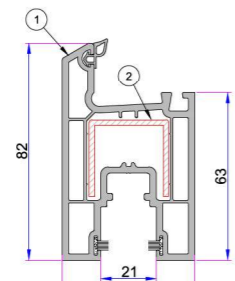

1. Sürme Kanat Profili
P.A.232.2300.600
2. Destek Sacı (29x30x29)
1,2mm - 34022 - 12002
1,5mm - 34022 - 15002
2 mm - 34022 - 20002

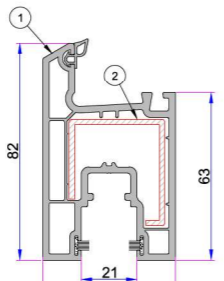

1. Statik Sürme Kanat Profili
P.A.232.2308.600
2. Destek Sacı (30x36x40x7)
1,2mm - 34022 - 12036
1,5mm - 34022 - 15036
2 mm - 34022 - 20036

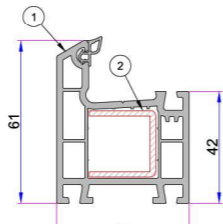

1. 332 Kasa Profili
P.A.332.1000.600
2. Destek Sacı (25x25x25)
1,2mm - 34022 - 12003
1,5mm - 34022 - 15003
2 mm - 34022 - 20003

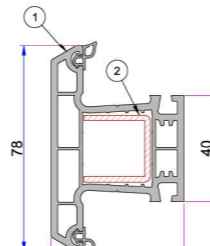

1. 332 Orta Kayıt Profili
P.A.332.3000.600
2. Destek Sacı (25x25x25)
1,2mm - 34022 - 12003
1,5mm - 34022 - 15003
2 mm - 34022 - 20003

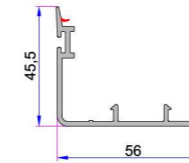

PVC Kanat Ara Bindirme Contası
P.A.232.5700.600

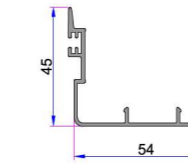

Alm. Kanat Arka Kapama
16051.601.5.1.1.9016

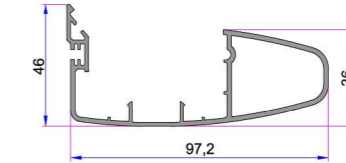

Alm. Kanat Arka Kapama Griyaj Profili
16028.601.5.2.0.9016

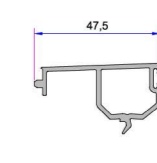

Tek Ray Kanal Kapama
P.A.232.5710.600

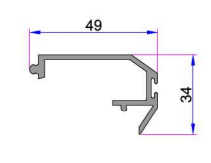

Alm. Kasa Kanal Kapama Profili
AD 16 - 013

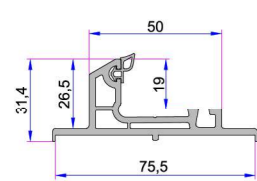

Çift Ray Adaptör Profili
P.A.232.5800.600

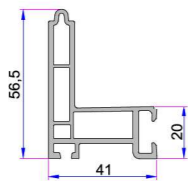

Sineklik Ray Profili
P.A.232.5802.600.0.00.19

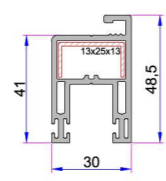

Sürme Sineklik Kanat Profili
P.A.242.2305.600.0.00.19

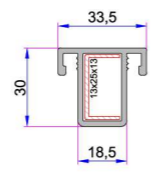

Sürme Sineklik Orta Kayıt Profili
P.A.242.3200.600.0.00.19

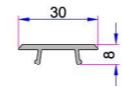

Sürme Sineklik Kanat Kapama
P.A.242.5701.600

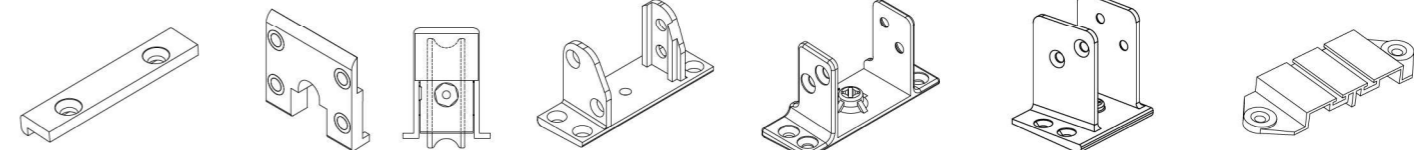

Sürme Üst Yatak Parçası
34009 - 36010

Sürme Alın Kapak
34009 - 46010

Sürme Teker
34009 - 18030

232 Kanattan Orta Kayıt Bağlantı Takozu
34007 - 14030

332 Orta Kayıt Bağlantı Takozu
34007 - 11080

Kasa-Kasa Bağlantı Takozu
34007-14020

Çift Ray Sızdırmazlık Parçası
34009 - 26010

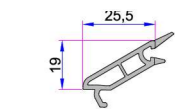

Tek Cam Çıtası (4 mm)
P.A.332.4000.600.0.HC

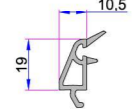

Çift Cam Çıtası (20 mm)
P.A.332.4100.600.0.HC

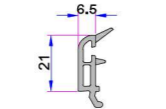

Çift Cam Çıtası (24 mm)
P.A.532.4500.600.0.HC

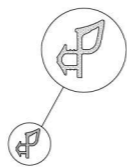

Kasa Contası

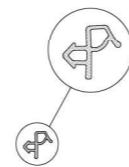

Kanat Contası

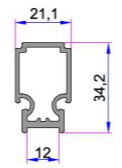

Alm. Çift Kanat Adaptörü
16011.601.5.1.1.9016

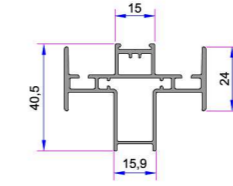

Alm. Kulaklı Çift Kanat Adaptörü
Profil YENİ Yapılacak

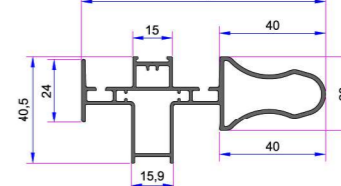

Alm. Griyajlı Çift Kanat Adaptörü
Profil YENİ Yapılacak

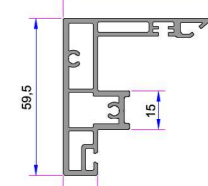

Üç Bölmeli Sürme Alm. Orta Kayıt Profili
Profil YENİ Yapılacak